

# ***RESOLUTION NO.: 114—2024-25***

TO THE HONORABLE, THE OUTAGAMIE COUNTY BOARD OF SUPERVISORS

LADIES AND GENTLEMEN:

***MAJORITY***

1 In accordance with Resolution No. 113, Outagamie County allocated remaining  
2 American Rescue Plan Act (ARPA) funds to support the implementation of the  
3 Total Rewards Compensation Study. This action, which includes funding employee  
4 wage increases, will result in savings of the County's General Fund, estimated to  
5 be up to \$4.25 million. These savings provide an opportunity for the County to  
6 reinvest in important County projects that will enhance employee infrastructure and  
7 promote a healthier and more supportive workplace.

8  
9 The first project is the Outagamie County Employee Child Care Center anticipated  
10 to be located at the former VPI space on the County's Brewster Village Campus.  
11 In 2023, Outagamie County, with assistance from Wipfli, conducted a survey to  
12 assess employee interest in an employee childcare center, which received a positive  
13 response. Building on this interest, the County engaged local childcare providers,  
14 including the YMCA, to explore potential partnership opportunities. Discussions  
15 led to the identification of the former VPI space as a suitable location for an  
16 employee childcare center. Subsequently, the County contracted with Martenson &  
17 Eisele to develop a design concept for the facility with input from the YMCA. In  
18 October 2024, the County received the final design concept and an opinion of  
19 probable cost. This resolution proposes to allocate General Fund savings to  
20 supplement the existing \$582,000 in the facilities management budget to cover  
21 construction costs for remodeling the former VPI space into a childcare center.  
22 Upon completion, the childcare center partnership aims to prioritize employee  
23 access to childcare as a strategy to attract and retain staff.

24  
25 The second project involves the Outagamie County Physical Therapy and Wellness  
26 Center, associated with the County's Employee Health Clinic. ThedaCare, who the  
27 County recently contracted to operate the Employee Health Clinic, will add  
28 physical therapy services to the clinic's offerings. The County engaged Martenson  
29 & Eisele to develop design plans for a dedicated physical therapy space at the  
30 County's Downtown Campus. This resolution proposes to allocate General Fund  
31 savings to fund construction costs required to build out this new physical therapy  
32 and wellness space.

33  
34 Should there be any remaining funds after completion of the two aforementioned  
35 projects, the remainder will be directed to the Healthcare Stabilization Fund. The  
36 County is actively working to transition the health plan to a self-funded model. This  
37 shift to self-funding offers the County potential cost savings, increased flexibility,  
38 enhanced decision-making capabilities, improved population health, and greater  
39 control to be innovative in healthcare delivery (e.g., promoting consumerism,  
40 developing creative health programs, etc.). It is recommended to maintain a balance  
41 of three months' worth of claims in the Healthcare Stabilization Fund, which would  
42 amount to approximately \$5 million, with the current balance being \$4.15 million.

1 Together, these projects will enhance employee wellness by providing convenient  
2 access to quality childcare, wellness/physical therapy services, and improved  
3 healthcare.  
4

5 NOW THEREFORE, the undersigned members of the Finance Committee recommend  
6 adoption of the following resolution.

7 BE IT RESOLVED, that the Outagamie County Board of Supervisors does hereby approve  
8 the reallocation of General Fund savings, which resulted from using ARPA funds to cover 2024  
9 employee wage increases, to support the development of the Outagamie County Employee Child  
10 Care Center as noted on the attached design concept and opinion of probable cost, which by  
11 reference are made a part hereof, and

12 BE IT FURTHER RESOLVED, that the Outagamie County Board of Supervisors does  
13 hereby approve the reallocation of General Fund savings, which resulted from using ARPA funds  
14 to cover 2024 employee wage increases, to support the development of the Outagamie County  
15 Physical Therapy Center as noted on the attached design concept, which by reference is made a  
16 part hereof, and

17 BE IT STILL FURTHER RESOLVED, that the Outagamie County Board of Supervisors  
18 does hereby approve the reallocation of any remaining General Fund savings, which resulted from  
19 using ARPA funds to cover 2024 employee wage increases, to the Healthcare Stabilization Fund  
20 as noted on the attached fiscal note, which by reference is made a part hereof, and

21 BE IT FINALLY RESOLVED, that the Outagamie County Clerk be directed to forward a  
22 certified copy of this resolution to the Outagamie County Finance Director, the Outagamie County  
23 Development and Land Services Director, the Outagamie County Facilities Director, and the  
24 Outagamie County Human Resources Director so they may proceed with the planning and  
25 implementation of these projects.  
26  
27

1  
2  
3  
4  
5  
6  
7  
8  
9  
10  
11  
12  
13  
14  
15  
16  
17  
18  
19  
20  
21  
22  
23  
24  
25  
26  
27  
28  
29  
30  
31  
32  
33

Respectfully Submitted,  
  
FINANCE COMMITTEE

\_\_\_\_\_  
Chris Croatt

\_\_\_\_\_  
John Cuff

\_\_\_\_\_  
Karen Lawrence

\_\_\_\_\_  
Dana Johnson

\_\_\_\_\_  
Rick Lautenschlager

Duly and officially adopted by the County Board on: \_\_\_\_\_

Signed: \_\_\_\_\_  
Board Chairperson

\_\_\_\_\_  
County Clerk

Approved: \_\_\_\_\_

Vetoed: \_\_\_\_\_

Signed: \_\_\_\_\_  
County Executive

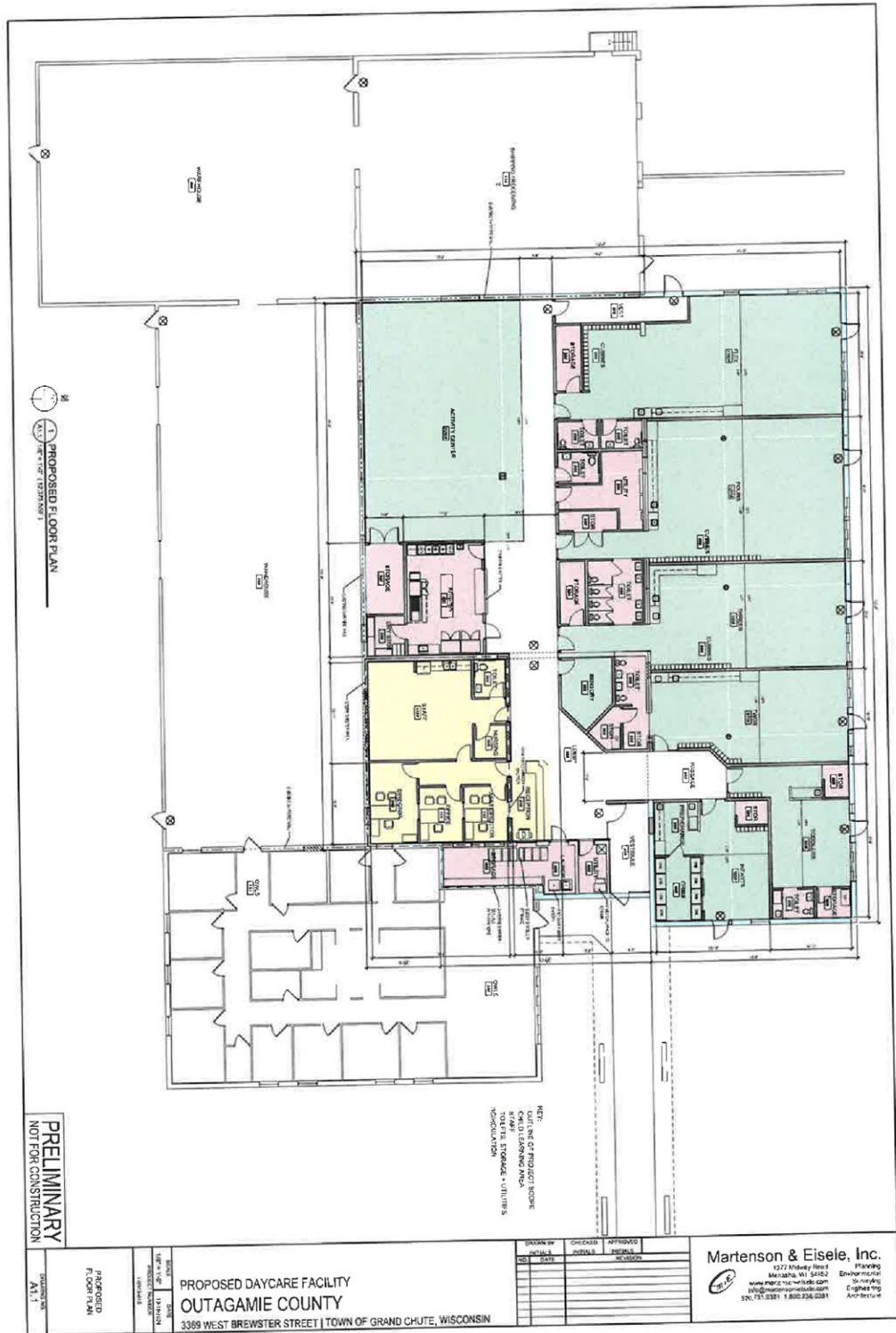

**PRELIMINARY**  
NOT FOR CONSTRUCTION

NOT TO SCALE  
DATE OF PROJECT WORK  
DATE OF SITE VISIT  
DATE OF EXISTING UTILITIES  
DATE OF CONSULTATION

DATE	DESCRIPTION

**PROPOSED DAYCARE FACILITY**  
**OUTAGAMIE COUNTY**  
3369 WEST BREWSTER STREET | TOWN OF GRAND CHUTE, WISCONSIN

DESIGNED BY	CHECKED BY	APPROVED BY

**Martenson & Eisele, Inc.**  
1277 Midway Blvd  
Madison, WI 53702  
www.martensoneisele.com  
608.278.1111 | 800.336.0281

PLANNING  
ENGINEERING  
ARCHITECTURE

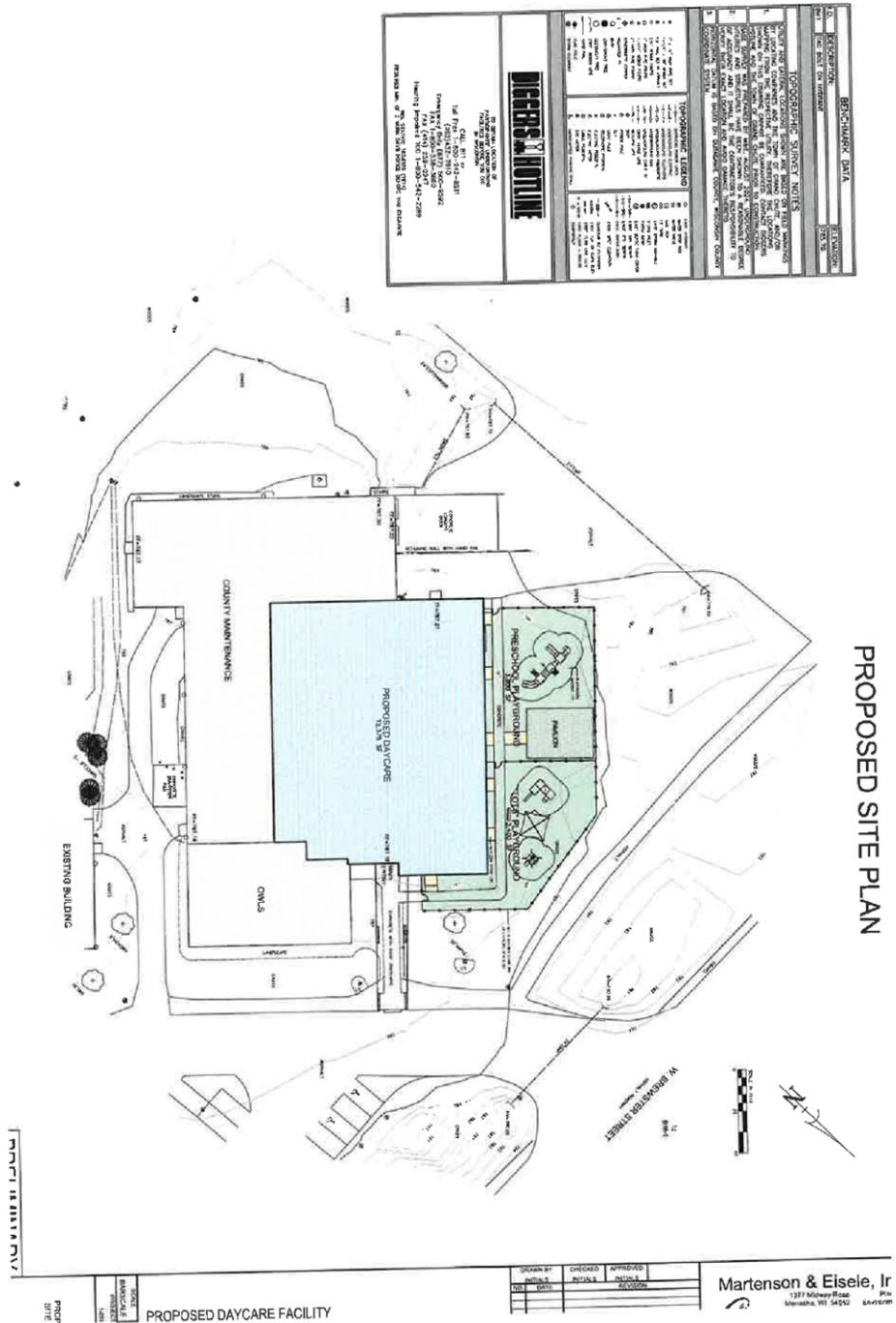

BENCHMARK DATA		ELEVATION	
NO.	DESCRIPTION	DATE	BY
1	1000	10/15/20	ME
2	1000	10/15/20	ME
3	1000	10/15/20	ME
4	1000	10/15/20	ME
5	1000	10/15/20	ME
6	1000	10/15/20	ME
7	1000	10/15/20	ME
8	1000	10/15/20	ME
9	1000	10/15/20	ME
10	1000	10/15/20	ME
11	1000	10/15/20	ME
12	1000	10/15/20	ME
13	1000	10/15/20	ME
14	1000	10/15/20	ME
15	1000	10/15/20	ME
16	1000	10/15/20	ME
17	1000	10/15/20	ME
18	1000	10/15/20	ME
19	1000	10/15/20	ME
20	1000	10/15/20	ME
21	1000	10/15/20	ME
22	1000	10/15/20	ME
23	1000	10/15/20	ME
24	1000	10/15/20	ME
25	1000	10/15/20	ME
26	1000	10/15/20	ME
27	1000	10/15/20	ME
28	1000	10/15/20	ME
29	1000	10/15/20	ME
30	1000	10/15/20	ME
31	1000	10/15/20	ME
32	1000	10/15/20	ME
33	1000	10/15/20	ME
34	1000	10/15/20	ME
35	1000	10/15/20	ME
36	1000	10/15/20	ME
37	1000	10/15/20	ME
38	1000	10/15/20	ME
39	1000	10/15/20	ME
40	1000	10/15/20	ME
41	1000	10/15/20	ME
42	1000	10/15/20	ME
43	1000	10/15/20	ME
44	1000	10/15/20	ME
45	1000	10/15/20	ME
46	1000	10/15/20	ME
47	1000	10/15/20	ME
48	1000	10/15/20	ME
49	1000	10/15/20	ME
50	1000	10/15/20	ME
51	1000	10/15/20	ME
52	1000	10/15/20	ME
53	1000	10/15/20	ME
54	1000	10/15/20	ME
55	1000	10/15/20	ME
56	1000	10/15/20	ME
57	1000	10/15/20	ME
58	1000	10/15/20	ME
59	1000	10/15/20	ME
60	1000	10/15/20	ME
61	1000	10/15/20	ME
62	1000	10/15/20	ME
63	1000	10/15/20	ME
64	1000	10/15/20	ME
65	1000	10/15/20	ME
66	1000	10/15/20	ME
67	1000	10/15/20	ME
68	1000	10/15/20	ME
69	1000	10/15/20	ME
70	1000	10/15/20	ME
71	1000	10/15/20	ME
72	1000	10/15/20	ME
73	1000	10/15/20	ME
74	1000	10/15/20	ME
75	1000	10/15/20	ME
76	1000	10/15/20	ME
77	1000	10/15/20	ME
78	1000	10/15/20	ME
79	1000	10/15/20	ME
80	1000	10/15/20	ME
81	1000	10/15/20	ME
82	1000	10/15/20	ME
83	1000	10/15/20	ME
84	1000	10/15/20	ME
85	1000	10/15/20	ME
86	1000	10/15/20	ME
87	1000	10/15/20	ME
88	1000	10/15/20	ME
89	1000	10/15/20	ME
90	1000	10/15/20	ME
91	1000	10/15/20	ME
92	1000	10/15/20	ME
93	1000	10/15/20	ME
94	1000	10/15/20	ME
95	1000	10/15/20	ME
96	1000	10/15/20	ME
97	1000	10/15/20	ME
98	1000	10/15/20	ME
99	1000	10/15/20	ME
100	1000	10/15/20	ME

DESIGNED BY	CHECKED BY	APPROVED BY
DATE	DATE	DATE

Martenson & Eisele, Ir  
 1377 Midway Road  
 Menasha, WI 54952  
 PLS  
 LAUREN

PROPOSED DAYCARE FACILITY

PROPOSED DAYCARE FACILITY



**Martenson & Eisele, Inc.**  
 professionals dedicated to serving people committed to improving their communities

Planning  
 Environmental  
 Surveying  
 Engineering  
 Architecture

**Project No. 1-0915-010**  
**OUTAGAMIE COUNTY - Proposed Daycare Remodel**  
**Brewster Site**

10/18/24

**Opinion of Probable Construction Costs**

<u>Description</u>	<u>Budget Cost</u>
<b>Division 1 - General Conditions / OH&amp;P</b>	<b>\$330,600</b>
Project Management / supervision	
Overhead and profit	
Insurance, bonds	
Construction permits and fees	
Dumpsters	
Construction equipment / material handling	
Project cleaning	
<b>Division 2 - Existing Conditions</b>	<b>\$128,000</b>
Selective building demolition	
<b>Division 3 - Concrete</b>	<b>\$35,000</b>
Precast structural plank	
Precast concrete topping	
New Concrete Stoops	
Concrete Patching	
<b>Division 4 - Masonry</b>	<b>\$23,500</b>
New CMU walls	
CMU infill	
Exterior wall infill	
<b>Division 5 - Metals</b>	<b>\$12,000</b>
Steel lintels and misc steel	
<b>Division 6 - Wood and Plastics</b>	<b>\$89,200</b>
Cabinets and countertops	
Blocking and misc carpentry	
<b>Division 7 - Thermal and Moisture Protection</b>	<b>\$12,700</b>
Flashing and sheet metal	
Firestopping	
Sealants	
<b>Division 8 - Openings</b>	<b>\$117,800</b>
HM frames	
FEMA HM doors and frames	
Prefinished wood interior doors	
Aluminum main entry doors, frames and accessible controls	
Aluminum doors and frames	
Aluminum windows	



**Martenson & Eisele, Inc.**  
professionals dedicated to serving people committed to improving their communities

Planning  
Environmental  
Surveying  
Engineering  
Architecture

Project No. 1-0915-010  
OUTAGAMIE COUNTY - Proposed Daycare Remodel  
Brewster Site

10/18/24

**Opinion of Probable Construction Costs**

<u>Description</u>	<u>Budget Cost</u>
Kitchen counter shutter FEMA Shutter Door hardware Glazing	
<b>Division 9 - Finishes</b>	<b>\$310,600</b>
Metal Stud, Gypsum board and veneer plaster Ceramic tile flooring and base Suspended acoustical panel ceiling system LVT / Vinyl plank flooring Vinyl wallbase Carpet tile Exterior painting Interior painting	
<b>Division 10 - Specialties</b>	<b>\$10,000</b>
Toilet room accessories (grab bars / mirror) Toilet room partitions Interior signage	
<b>Division 22 - Plumbing</b>	<b>\$258,000</b>
Kohler / Sloan plumbing fixtures Single bowl Elkay lavatories and sinks Water heater(s) Waste pipe trenching Piping and Insulation Kitchen hand sink Kitchen 3-compartment sink Kitchen grease trap	
<b>Division 23 - Heating, Ventilating and Air-Conditioning</b>	<b>\$105,000</b>
Restroom exhaust fans Grilles, diffusers and registers Connections to existing HVAC systems Ductwork - insulated as required Commercial Kitchen Hood	
<b>Division 26 - Electrical</b>	<b>\$143,000</b>
Duplex receptacles and switches including GFI Cat-5 data cabling and outlets - final hookups by owner vendor Occupancy sensors for lighting where required 24x24 LED lay-in lights in suspended acoustical ceiling (dimnable) LED 'wafer' recessed lights (dimnable)	



**Martenson & Eisele, Inc.**  
 professionals dedicated to serving people committed to improving their communities

Planning  
 Environmental  
 Surveying  
 Engineering  
 Architecture

Project No. 1-0915-010  
**OUTAGAMIE COUNTY - Proposed Daycare Remodel  
 Brewster Site**

10/18/24

**Opinion of Probable Construction Costs**

<u>Description</u>	<u>Budget Cost</u>
LED exit signs Wiring of mechanical and plumbing equipment	<b>\$9,400</b>
<b>Division 27 - Communications</b> Update communications / fiber	<b>\$17,000</b>
<b>Division 28 - Security Systems</b> New fire alarm panel and system	<b>\$5,000</b>
<b>Division 31 - Earthwork</b> Minor grading for walks and playground	<b>\$46,200</b>
<b>Division 32 - Site Improvements</b> Demo existing asphalt and stoops Concrete sidewalks Playground matting Fencing	<b>\$1,653,000</b>
<b>Construction Subtotal</b>	<b>\$1,653,000</b>
Contingency (Design and Construction) 15%	\$165,300
A/E Design Fee 9%	\$148,770
Permits / Fees	\$10,000
Asbestos Abatement	TBD
<b>Total Opinion of Probable Construction Costs</b>	<b>\$1,967,070</b>
Building Construction Area	12,375 NSF
Playground Equipment, Kitchen Equipment, Classroom and Office Furnishings and Equipment Not Included	



**OUTAGAMIE COUNTY FISCAL NOTE**

**INTRODUCTION:** This form must be attached to any resolution or ordinance which contains a spending or revenue proposal. The form should be completed by an individual within the department initiating the resolution or ordinance with assistance from the Financial Services Department. Contact the Finance Director (1674), Controller (1675) or Staff Accountant (1681) for assistance. Once completed, forward a copy of the form to the Financial Services Department for their review. Financial Services will forward a reviewed copy of the fiscal note to Legislative Services.

1. **Subject:** Total Rewards Implementation Savings allocation

2. **Description:** This section must be completed for all fiscal notes. Briefly and concisely describe the request. State assumptions used and discuss any current year and long-term fiscal impacts. (A separate attachment can be used)

With the allocation of remaining ARPA funding to the Total Rewards Implementation, the savings will be used to fund the following projects at up to an estimated \$4.25 million. These savings will be used for the following projects:

- Outagamie County Employee Childcare Center
- Outagamie County Physical Therapy and Wellness Center
- Healthcare Stabilization Fund

**Current Year Budget Impact (Check one or more of the following boxes)**

- Revenues                       Expenses (Cost)                       None
3. Is the specific cost or revenue included in the current year's budget?      yes ( )    no ( x )    partially ( )
4. If the proposal requests additional spending, can the additional cost be absorbed within the current year's line item?      yes ( )    no ( x )    n/a ( )
5. Is the proposal to accept additional revenues only?                              yes ( )    no ( x )
6. Does this request modify/adjust the current year budget?                      yes ( )    no ( x )  
If no, skip to question 8 below.
7. Detail current year budget changes. Please list cost center name, line item, account number and either the increase or decrease amount. (Please note that all budget adjustments must balance. For example, an increase in an expenditure account must be offset by a decrease in another expenditure account or the contingency fund or an increase in a revenue account or other funding sources such as fund balance applied.)  
The project on

COST CENTER NAME	LINE ITEM (i.e. Salaries, Supplies, Etc.)	ACCOUNT NUMBER INCLUDING COST CENTER (i.e. 1004100.5100, 1004100.5400, etc.)	INCREASE (DECREASE) AMOUNT
Child Care Center	Purchased Services/ Capital	TO BE DETERMINED	TO BE DETERMINED
Physical Therapy & Wellness Center	Purchased Services/ Capital	TO BE DETERMINED	TO BE DETERMINED
Healthcare Stabilization	Operating Transfer	6070100.8900	TO BE DETERMINED
General fund	Committed Funds	1000000.3869/3867	TO BE DETERMINED

**Annual and Long-Term Impact**  
8. Is the above Increase/Decrease a nonrecurring one-time expense or revenue?      yes ( )    no ( )    n/a ( )

9. What is the anticipated annual and/or long-term cost or revenue impact?      Annual Cost \_\_\_\_\_  
Annual Revenue 0

Fiscal Note Prepared by: Kevin Englebert/Michelle Uitenbroek

For Financial Services purposes only	
Reviewed By: <i>Michelle Uitenbroek</i>	If expenditures are recorded in the financial system at a level of detail lower than the level 6 as shown above, indicate the specific account numbers and amounts below: <u>Detail Expenditure Account Number</u> <u>Amount</u>
Date: 11/26/2024	
Comments:	